

ENX 16 EASY Encoder Ø16 mm, 1...1024 CPT

ENX



Key Data		EASY Incremental Differential
Number of channels		3
Max. counts per turn		1024
Encoder length L ²	mm	8.5
Ambient temperature	°C	-40 ... +100
Weight	g	7

Selection criteria		EASY Incremental Differential
Speed and rotation direction detection		■
Speed and position control		■
Compact and robust design		■
High resolution		■
Cost effective		■

■ suitable ▲ suitable to a limited extent ● not suitable

Specifications		EASY Incremental Differential
Supply voltage V _{cc}	V	5 ±0.5
Typical current draw	mA	22
Max. operating frequency	kHz	1600
Max. Speed	rpm	30 000
Connector		10-pin 2.54 mm multipoint connector (IEC/EN 60603-13 / DIN41651)
		Pin 1 Not connected
		Pin 2 V _{CC}
		Pin 3 GND
		Pin 4 Not connected
		Pin 5 Channel Ā
		Pin 6 Channel A
		Pin 7 Channel B̄
		Pin 8 Channel B
		Pin 9 Channel Ī
		Pin 10 Channel I
		Output signal: EIA-Standard RS 422
		Output current per channel: ± 20 mA

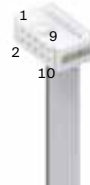

Configuration		EASY Incremental Differential
Counts per turn ¹		1 ... 1024
Cable length	mm	50, 100, 150, 200, 300, 500, 1000
Alignment of cable outlet in relation to motor flange	°	15

maxon Modular System	Page	Dimensions Standard Version	M 3:4	Notes
maxon DC motor				
DCX 16 S	93-94			¹ maxon controllers require a resolution of at least 16 counts per turn. ² For attachment to DCX motors: plus 2-4 mm thick intermediate plate.
DCX 16 L	95-96			
DCX 19 S	97-98			
DCX 22 S	99-100			
DCX 22 L	101-102			
DCX 26 L	103-104			
DCX 32 L	105			
DCX 35 L	106			
DC-max 26 S	113-114			

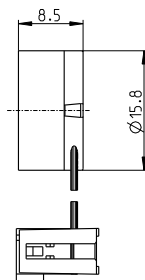

Also available in combination with BLDC motors (see pages 464-465)

xdrives.maxongroup.com