

IDX 56 M with integrated electronics

Drive with Positioning/Speed Controller



Key Data: 230/256 W, 516 mNm, 6000 rpm

M 1:2

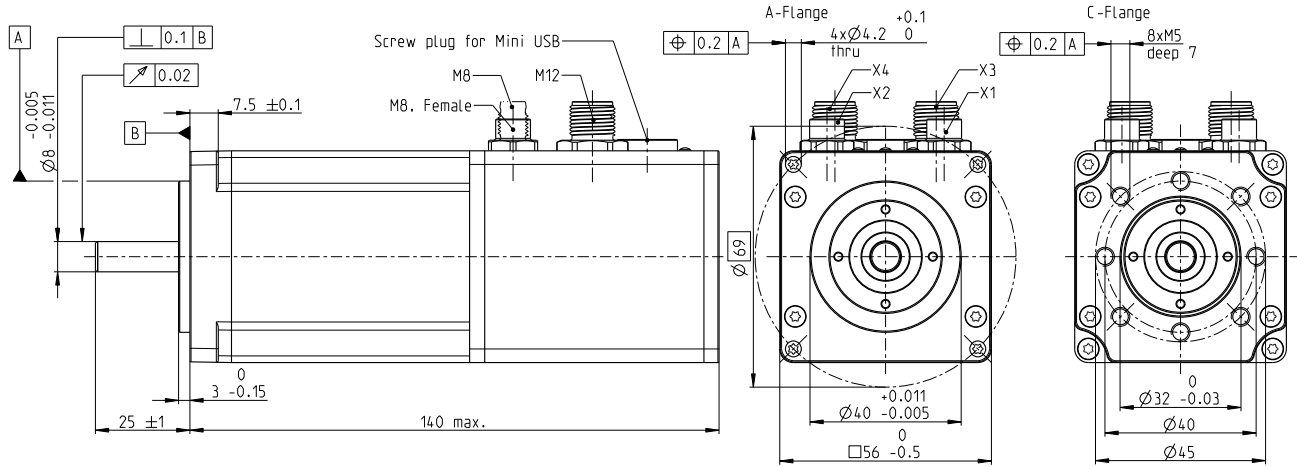

Drive data (provisional)

1_	Nominal power supply voltage	V	24	48
2_	Nominal speed	rpm	4477	4500
3_	Nominal torque at 25°C	mNm	433	516
4_	Nominal torque at 40°C	mNm	376	458
5_	Nominal supply current at 25°C	A	10.0	5.8
6_	Nominal supply current at 40°C	A	8.7	5.2
7_	Maximum speed at nominal voltage	rpm	5227	6000
8_	Maximum permissible drive speed	rpm	6000	6000
9_	Maximum torque (short-time)	mNm	948	1498
10_	Maximum supply current (short-time)	A	24	24
11_	Rotor inertia of the drive	gcm ²	170	170
12_	Nominal supply voltage + V _{CC}	V	12..48	12..48
13_	Mechanical time constant	ms	0.654	0.693

Thermal data

14_	Thermal resistance housing-ambient	K/W	2.47
15_	Thermal resistance winding-housing	K/W	1.16
16_	Thermal time constant winding	s	18.9
17_	Thermal time constant drive	s	1320
18_	Ambient temperature	°C	-30...+85

Operating Range

n [rpm] 24-V-system

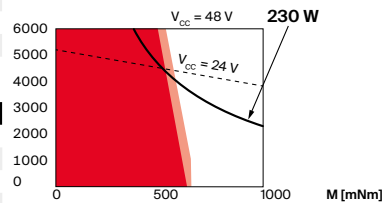

Mechanical data

19_	Axial play	mm	0.14
	Preload	N	16
	Direction of force		Pull
20_	Radial play	preloaded	
21_	Max. axial load (dynamic)	N	12
22_	Max. force for press fits (static)	N	150
23_	Max. radial load [mm from flange]	N	110 [12.5]

n [rpm] 48-V-system

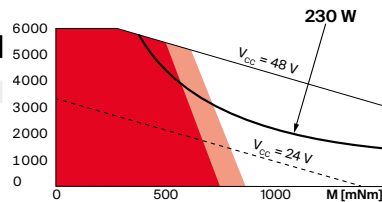

Other specifications

24_	Weight of the drive	g	1070
25_	Typical noise level [rpm]	dBA	54 [4000]
	Encoder: Steps per turn		4096

Supply	M12, male, 5 poles, L-coded
I/O's	M12, male, 12 poles, A-coded
CANopen Input	M8, male, 5 poles, B-coded
CANopen Output	M8, female, 5 poles, B-coded
EtherCAT Input	M8, female, 4 poles, A-coded
EtherCAT Output	M8, female, 4 poles, A-coded

- Continuous operation
- Continuous operation with reduced thermal resistance R_{th2} 50%
- Short term operation

Modular System

Gear	Stages [opt.]	Sensor	Motor Control
390_GPX 52 A/UP	1-3	integrated	integrated
391_GPX 52 LN	1-3		
Accessories			
569_AB 42 S			

Details on catalog page 40

Configuration

Flange front: A-Flange/C-Flange
 Interface with Positioning/Speed Controller: CANopen / EtherCAT
 Interface with Speed Controller: I/O