

Planetary Gearhead GP 32 HP $\varnothing 32$ mm, 4.0–8.0 Nm

High Power

gear

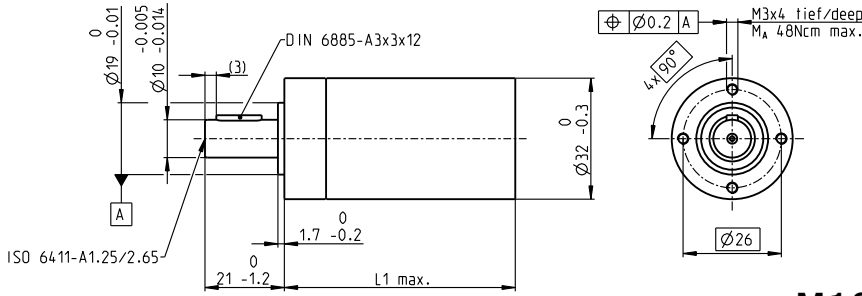

M 1:2

Technical Data

Planetary Gearhead	straight teeth
Output shaft	stainless steel
Bearing at output	ball bearing
Radial play, 10 mm from flange	max. 0.14 mm
Axial play	max. 0.4 mm
Max. axial load (dynamic)	120 N
Max. force for press fits	120 N
Direction of rotation, drive to output	=
Max. continuous input speed	8000 rpm
Recommended temperature range	-40...+100°C
Number of stages	2 3 4
Max. radial load, 10 mm from flange	200 N 250 N 300 N

Gearhead Data	Part Numbers						
	320247	326663	326664	326668	326672	324947	324952
1 Reduction	14:1	33:1	51:1	111:1	190:1	456:1	706:1
2 Absolute reduction	$\frac{676}{49}$	$\frac{529}{16}$	$\frac{17576}{343}$	$\frac{13824}{125}$	$\frac{456976}{2401}$	$\frac{89401}{196}$	$\frac{158171}{224}$
3 Max. motor shaft diameter	6 mm	3	6	4	6	3	3
Part Numbers	326659		326665	326669	324942	324948	324953
1 Reduction	18:1		66:1	123:1	246:1	492:1	762:1
2 Absolute reduction	$\frac{624}{35}$		$\frac{16224}{245}$	$\frac{6877}{56}$	$\frac{421824}{1715}$	$\frac{86112}{175}$	$\frac{19044}{25}$
3 Max. motor shaft diameter	6 mm		6	3	6	6	4
Part Numbers	326660		326666	326670	324944	324949	324954
1 Reduction	21:1		79:1	132:1	295:1	531:1	913:1
2 Absolute reduction	$\frac{299}{14}$		$\frac{3887}{49}$	$\frac{3317}{25}$	$\frac{101062}{343}$	$\frac{331776}{625}$	$\frac{36501}{40}$
3 Max. motor shaft diameter	6 mm		6	4	6	4	3
Part Numbers	326661		326667	326671	324945	324950	
1 Reduction	23:1		86:1	159:1	318:1	589:1	
2 Absolute reduction	$\frac{576}{25}$		$\frac{14976}{175}$	$\frac{1587}{10}$	$\frac{389376}{1225}$	$\frac{20631}{35}$	
3 Max. motor shaft diameter	4 mm		6	3	6	6	
Part Numbers	326662		320297		324946	324951	
1 Reduction	28:1		103:1		411:1	636:1	
2 Absolute reduction	$\frac{139}{5}$		$\frac{3588}{35}$		$\frac{359424}{675}$	$\frac{79488}{125}$	
3 Max. motor shaft diameter	4 mm		6		6	4	
4 Number of stages	2	2	3	3	4	4	4
5 Max. continuous torque	4 Nm	4	8	8	8	8	8
6 Max. intermittent torque at gear output	6 Nm	6	12	12	12	12	12
7 Max. efficiency	75 %	75	70	70	60	60	60
8 Weight	178 g	178	213	213	249	249	249
9 Average backlash no load	0.8 °	0.8	1.0	1.0	1.0	1.0	1.0
10 Mass inertia	1.6 gcm ²	0.5	1.5	0.7	1.5	1.5	0.7
11 Gearhead length L1	48.3 mm	48.3	55.0	55.0	61.7	61.7	61.7

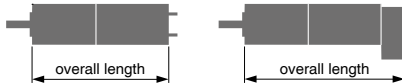

maxon Modular System										
+ Motor	Page	+ Sensor/Brake	Page	Overall length [mm] = Motor length + gearhead length + (sensor/brake) + assembly parts						
RE 35, 90 W	149			119.4	119.4	126.1	126.1	132.8	132.8	132.8
RE 35, 90 W	149	MR	479	130.8	130.8	137.5	137.5	144.2	144.2	144.0
RE 35, 90 W	149	HEDL 5540	486/488	140.1	140.1	146.8	146.8	153.5	153.5	153.5
RE 35, 90 W	149	DCT 22	495	137.5	137.5	144.2	144.2	150.9	150.9	150.9
RE 35, 90 W	149	AB 28	535	155.5	155.5	162.2	162.2	168.9	168.9	168.9
RE 35, 90 W	149	HEDS 5540/AB 28	486/535	172.7	172.7	179.4	179.4	186.1	186.1	186.1
EC-max 30, 40 W	250			90.4	90.4	97.1	97.1	103.8	103.8	103.8
EC-max 30, 40 W	250	MR	478	102.6	102.6	109.3	109.3	116.0	116.0	116.0
EC-max 30, 40 W	250	HEDL 5540	490	111.0	111.0	117.7	117.7	124.4	124.4	124.4
EC-max 30, 40 W	250	AB 20	532	126.0	126.0	132.7	132.7	139.4	139.4	139.4
EC-max 30, 40 W	250	HEDL 5540/AB 20	490/532	146.6	146.6	153.3	153.3	160.0	160.0	160.0
EC-max 30, 60 W	251			112.4	112.4	119.1	119.1	125.8	125.8	125.8
EC-max 30, 60 W	251	MR	478	124.6	124.6	131.3	131.3	138.0	138.0	138.0
EC-max 30, 60 W	251	HEDL 5540	490	133.0	133.0	139.7	139.7	146.4	146.4	146.4
EC-max 30, 60 W	251	AB 20	532	148.0	148.0	154.7	154.7	161.4	161.4	161.4
EC-max 30, 60 W	251	HEDL 5540/AB 20	490/532	168.6	168.6	175.3	175.3	182.0	182.0	182.0
EC-4pole 30, 100 W	259			95.4	95.4	102.1	102.1	108.8	108.8	108.8
EC-4pole 30, 100 W	259	22 EMT	457	123.3	123.3	130.0	130.0	136.7	136.7	136.7
EC-4pole 30, 100 W	259	16 EASY/XT/Abs.	464-468	109.3	109.3	116.0	116.0	122.7	122.7	122.7
EC-4pole 30, 100 W	259	16 EASY Abs. XT	470	109.8	109.8	116.5	116.5	123.2	123.2	123.2
EC-4pole 30, 100 W	259	16 RIO	481	107.8	107.8	114.5	114.5	121.2	121.2	121.2
EC-4pole 30, 100 W	259	AEDL/HEDL	484/490	116.0	116.0	122.7	122.7	129.4	129.4	129.4
EC-4pole 30, 100 W	259	AB 20	532	131.6	131.6	138.3	138.3	145.0	145.0	145.0
EC-4pole 30, 100 W	259	22 EMT/AB 20	457/532	162.8	162.8	169.5	169.5	176.2	176.2	176.2
EC-4pole 30, 100 W	259	16 EASY/XT/Abs./AB 20	464/532	145.7	145.7	152.4	152.4	159.1	159.1	159.1
EC-4pole 30, 100 W	259	16 EASY Abs. XT/AB 20	470/532	146.2	146.2	152.9	152.9	159.6	159.6	159.6
EC-4pole 30, 100 W	259	16 RIO/AB 20	481/532	144.2	144.2	150.9	150.9	157.6	157.6	157.6
EC-4pole 30, 100 W	259	AEDL/HEDL/AB 20	484/532	152.2	152.2	158.9	158.9	165.6	165.6	165.6

Planetary Gearhead GP 32 HP $\varnothing 32$ mm, 4.0–8.0 Nm

High Power

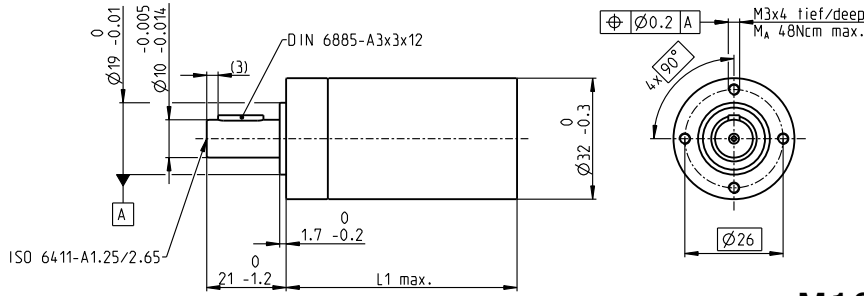

M 1:2

Technical Data	
Planetary Gearhead	straight teeth
Output shaft	stainless steel
Bearing at output	ball bearing
Radial play, 10 mm from flange	max. 0.14 mm
Axial play	max. 0.4 mm
Max. axial load (dynamic)	120 N
Max. force for press fits	120 N
Direction of rotation, drive to output	=
Max. continuous input speed	8000 rpm
Recommended temperature range	-40...+100°C
Number of stages	2 3 4
Max. radial load, 10 mm from flange	200 N 250 N 300 N

gear

	Part Numbers						
	320247	326663	326664	326668	326672	324947	324952
Gearhead Data							
1 Reduction	14:1	33:1	51:1	111:1	190:1	456:1	706:1
2 Absolute reduction	$\frac{676}{49}$	$\frac{529}{16}$	$\frac{17576}{343}$	$\frac{13824}{125}$	$\frac{456976}{2401}$	$\frac{89401}{196}$	$\frac{158171}{224}$
3 Max. motor shaft diameter mm	6	3	6	4	6	3	3
Part Numbers	326659		326665	326669	324942	324948	324953
1 Reduction	18:1		66:1	123:1	246:1	492:1	762:1
2 Absolute reduction	$\frac{624}{35}$		$\frac{16224}{245}$	$\frac{6877}{56}$	$\frac{421824}{1715}$	$\frac{86112}{175}$	$\frac{19044}{25}$
3 Max. motor shaft diameter mm	6		6	3	6	6	4
Part Numbers	326660		326666	326670	324944	324949	324954
1 Reduction	21:1		79:1	132:1	295:1	531:1	913:1
2 Absolute reduction	$\frac{299}{14}$		$\frac{3887}{49}$	$\frac{3312}{25}$	$\frac{101062}{343}$	$\frac{331776}{625}$	$\frac{36501}{40}$
3 Max. motor shaft diameter mm	6		6	4	6	4	3
Part Numbers	326661		326667	326671	324945	324950	
1 Reduction	23:1		86:1	159:1	318:1	589:1	
2 Absolute reduction	$\frac{576}{25}$		$\frac{14976}{175}$	$\frac{1587}{10}$	$\frac{389376}{1225}$	$\frac{20633}{35}$	
3 Max. motor shaft diameter mm	4		6	3	6	6	
Part Numbers	326662		320297		324946	324951	
1 Reduction	28:1		103:1		411:1	636:1	
2 Absolute reduction	$\frac{138}{5}$		$\frac{3588}{35}$		$\frac{359424}{875}$	$\frac{79488}{125}$	
3 Max. motor shaft diameter mm	4		6		6	4	
4 Number of stages	2	2	3	3	4	4	4
5 Max. continuous torque Nm	4	4	8	8	8	8	8
6 Max. intermittent torque at gear output Nm	6	6	12	12	12	12	12
7 Max. efficiency %	75	75	70	70	60	60	60
8 Weight g	178	178	213	213	249	249	249
9 Average backlash no load °	0.8	0.8	1.0	1.0	1.0	1.0	1.0
10 Mass inertia gcm ²	1.6	0.5	1.5	0.7	1.5	1.5	0.7
11 Gearhead length L1 mm	48.3	48.3	55.0	55.0	61.7	61.7	61.7



maxon Modular System										
+ Motor	Page	+ Sensor/Brake	Page	Overall length [mm] = Motor length + gearhead length + (sensor/brake) + assembly parts						
EC-4pole 30, 200 W	261			112.4	112.4	119.1	119.1	125.8	125.8	125.8
EC-4pole 30, 200 W	261	22 EMT	457	140.3	140.3	147.0	147.0	153.7	153.7	153.7
EC-4pole 30, 200 W	261	16 EASY/XT/Abs.	464-468	126.3	126.3	133.0	133.0	139.7	139.7	139.7
EC-4pole 30, 200 W	261	16 EASY Abs. XT	470	126.8	126.8	133.5	133.5	140.2	140.2	140.2
EC-4pole 30, 200 W	261	16 RIO	481	124.8	124.8	131.5	131.5	138.2	138.2	138.2
EC-4pole 30, 200 W	261	AEDL/HEDL	484/490	133.0	133.0	139.7	139.7	146.4	146.4	146.4
EC-4pole 30, 200 W	261	AB 20	532	148.6	148.6	155.3	155.3	162.0	162.0	162.0
EC-4pole 30, 200 W	261	22EMT/AB 20	457/532	179.8	179.8	186.5	186.5	193.2	193.2	193.2
EC-4pole 30, 200 W	261	16 EASY/XT/Abs./AB 20	464/532	162.7	162.7	169.4	169.4	176.1	176.1	176.1
EC-4pole 30, 200 W	261	16 EASY Abs. XT/AB 20	470/532	163.2	163.2	169.9	169.9	176.6	176.6	176.6
EC-4pole 30, 200 W	261	16 RIO/AB 20	481/532	161.2	161.2	167.9	167.9	174.6	174.6	174.6
EC-4pole 30, 200 W	261	AEDL/HEDL/AB 20	490/532	169.2	169.2	175.9	175.9	182.6	182.6	182.6